

# APPLICATION GUIDE 2 NATURAL STONE – TRADITIONAL AND AGEING METHOD

## APPLICATION BY HAND

Reclaimed flagstones, rough cut, honed and tumbled natural stone.



Using traditional oil and wax based sealers will greatly enhance the appearance and if desired also provide stone surfaces with an instantly aged appearance. Traditional sealers will give natural stone a softer natural look. The following guide will explain the process and help keep your surfaces maintained and in good condition for many years.

### THREE STEP INSTALLATION INSTRUCTION OVERVIEW (SEE PAGE TWO FOR REFURBISHING EXISTING) March 2022

#### LTP GRIMEX

#### INITIAL CLEANING OF NEWLY INSTALLED SURFACES

LTP GRIMEX – Cleans and removes grease, dirt & grime.

1

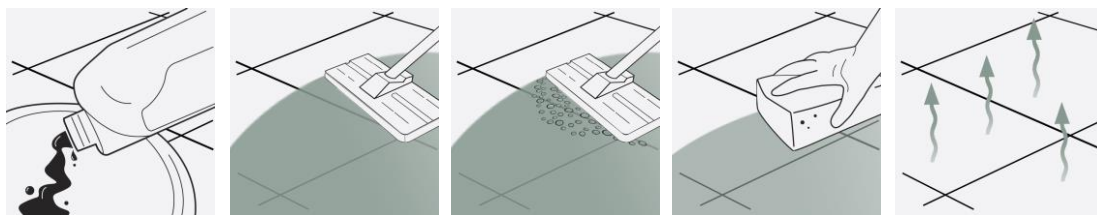

**STEP 1.**  
Dilute solution 1:10 with warm water and apply to the surface.

**STEP 2.**  
Working in manageable areas at a time spread out the solution. Leave for 20 minutes.

**STEP 3.**  
Add a little water and then scrub surfaces and grout joints to release sediment dirt and grime. Use white pad and pad holder.

**STEP 4.**  
Sponge up released residues. Rinse with water a second time and sponge again.

**STEP 5.**  
Allow surfaces to dry before allowing traffic or sealing.

#### LTP STONE OIL

#### PROTECT AGAINST STAINS -

LTP STONE OIL- will help protect against water, oil, grease, dirt, grime and aid maintenance.  
LTP CLEAR WAX or LTP ANTIQUE WAX (Aged appearance)-internal surfaces only.

2



LTP CLEAR WAX  
or  
LTP ANTIQUE WAX

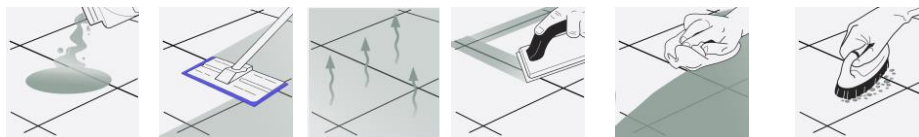

**STEP 1.**  
Before grouting: apply sealing solution sparingly to the surface. Underfloor heating must be off.

**STEP 2.**  
Spread out evenly using a paint brush, soft cloth or sealant applicator pad and pad holder.

**STEP 3.**  
Allow sealer to absorb and dry. Apply further coats at 2 hour intervals until it will absorb no more. Wipe away excess and leave to dry.

**STEP 4.**  
Leave sealer to cure overnight before grouting the joints. Clean off grout residues and leave to dry.

**STEP 5.**  
Apply wax generously and work into the surface with a cloth.

**STEP 6.**  
Leave the wax for 20 minutes and then buff to a shine with a stiff brush. Allow light traffic for the first 12 hours and do not wash the surfaces for 3 days.

#### LTP WAXWASH

#### REGULAR AFTERCARE

LTP WAXWASH – Maintains sealed natural tile surfaces. Ph Neutral

3

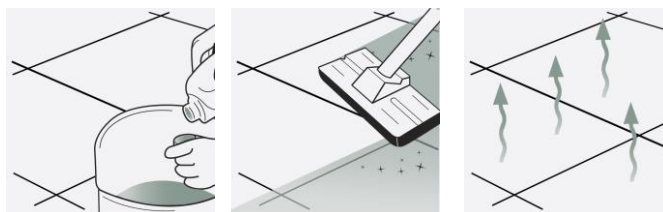

**STEP 1.**  
Dilute 1 capful of cleaner per litre of warm water.

**STEP 2.**  
Mop surfaces with the solution. Do not rinse.

**STEP 3.**  
Allow to dry. Do not walk on surface during drying time. (20 minutes).

A 1 ltr LTP Waxwash will wash a 20 m<sup>2</sup> floor approx 40 times



For any LTP product information call our technical helpline  
+ 44 (0) 1823 666213 | [www.ltp-online.co.uk](http://www.ltp-online.co.uk) | [technical@ltp-online.co.uk](mailto:technical@ltp-online.co.uk)  
Tone Est, Milverton Road, Wellington, Somerset, TA21 0AN



# APPLICATION GUIDE 2 NATURAL STONE – TRADITIONAL AND AGEING METHOD

## APPLICATION BY HAND

Reclaimed flagstones, rough cut, honed and tumbled natural stone.



### EQUIPMENT REQUIRED:

LTP Tools - 4pc pole, pad holder, sealant applicator, white or black emulsifying pad, deck brush, claw brush, buffing cloths, buckets, sponges, mops. Ensure that any sensitive surfaces not to be cleaned are properly covered and protected before beginning. Ensure that gloves, eye protection and suitable water proof clothing are worn at all times.

### 1 CLEANING AND REFURBISHING – used and heavily soiled surfaces

- Before sealing the surface must be thoroughly cleaned. Old layers of sealer, residues from aftercare products and deposits must be removed from the surface and pores of the tiles.
- Depending upon the levels of old wax and dirt, first remove old layers of wax with **LTP Solvex**.
- Dilute **LTP Grimex** 1:3 with warm water and apply liberally to the surface with a sponge, cloth or mop.
- Agitate the surface with a nylon pad or scrubbing brush and leave for a further 5-10 minutes (scrubber machines can be used on harder stone surfaces)
- Continue to scrub while adding clean water. Remove residues from the surface using a cloth or scrubber dryer machine.
- Rinse thoroughly with clean fresh water to remove all remaining residues.
- For the removal of other types of dirt see the table below.

### OTHER TYPES OF DIRT

Cement residues, limescale and organic matter.

LTP Grout Stain Remover or LTP Powerstripper

Tar, wax paint, bitumen and epoxy grout residues

LTP Solvex

Rust stains

LTP Rust Stain Remover

Algae Deposits / organic matter

LTP Blackspot & Algae Remover

### 2 PROTECTIVE SEAL TREATMENTS

- **LTP Stone Oil** and **LTP Clear Wax** or **LTP Antique Wax** will render the surface, water and oil repellent.
- These products help prevent staining, aid cleaning and simplify the removal of stains.
- **LTP Stone Oil** will deepen colour and enhance the natural character.
- **LTP Clear Wax** or **Antique Wax** will provide an easily maintainable hard wearing satin finish.
- **LTP Clear Wax** or **Antique Wax** is film forming so should not be used externally or used on surfaces that are damp or have no damp proof course.
- There are no health concerns once the product has properly cured.
- **LTP Stone Oil** is suitable for internal and external use.
- If surfaces are properly maintained we recommend touching up the protective treatment every 3-4 years.

NB. Always test products on an inconspicuous area before general application. Surfaces that are non absorbent or saturated with moisture cannot be treated. **LTP Stone Oil** is an impregnating sealer that needs to be fully absorbed. Any un-absorbed sealer should be buffed off with a micro-fibre cloth or machine with white pad and a little white spirit to remove the excess.

### 3 AFTERCARE



#### LTP Waxwash (for Floors)

Formulated for use on travertine, stone, limestone, slate, terracotta and quarry. Ideal for washing surfaces finished with **LTP Clear** or **Antique Wax**. Use routinely in place of normal detergents



#### LTP Stonewash (for walls)

This gentle surface cleaner is formulated for use on limestone, marble, granite, slate and polished porcelain. Will clean without breaking down and removing protective seals.

NB. Always follow detailed instructions on the product labels. Protect acid sensitive stone surfaces from contact with acidic substances. Do not use abrasive materials on honed and polished stones. Avoid using steam cleaners, jet washers, normal detergents or strong bleach cleaners on sealed surfaces as they can cause damage to the stone and will gradually remove the protective seal.

*This information is offered without guarantee. The material should be used so as to take account of the local conditions and the surfaces to be treated. In case of doubt, the product should be tried out in an inconspicuous area*



For any LTP product information call our technical helpline  
+ 44 (0) 1823 666213 | [www.ltp-online.co.uk](http://www.ltp-online.co.uk) | [technical@ltp-online.co.uk](mailto:technical@ltp-online.co.uk)  
Tone Est, Milverton Road, Wellington, Somerset, TA21 0AN

