

# APPLICATION GUIDE 4

## NATURAL STONE - (WET ROOMS AND SWIMMING POOL SURROUNDS)

### APPLICATION BY HAND

Unpolished, Travertine, Limestone, Marble, Sandstone, Slate, Terrazzo and Granite



Natural stone has been a popular choice of cladding material in wet rooms and around swimming pools for centuries. As with all natural materials, it does require a certain level of care. The following instructions are a guide to help ensure that stone surfaces will remain protected and easy to clean for many years.

**PLEASE NOTE:** Before grouting wash surfaces well with LTP Grimex and once clean and thoroughly dry, apply a minimum of one coat of LTP Colour Intensifier & Stainblock. This treatment will assist with the removal of residual grout and protect the surface of the stone.

## THREE STEP INSTALLATION INSTRUCTION OVERVIEW (SEE PAGE TWO FOR REFURBISHING EXISTING) MARCH 2022

### LTP GRIMEX



### INITIAL CLEANING OF NEWLY INSTALLED SURFACES IF REQUIRED

**LTP GRIMEX:** Cleans and removes grease, dirt & grime.

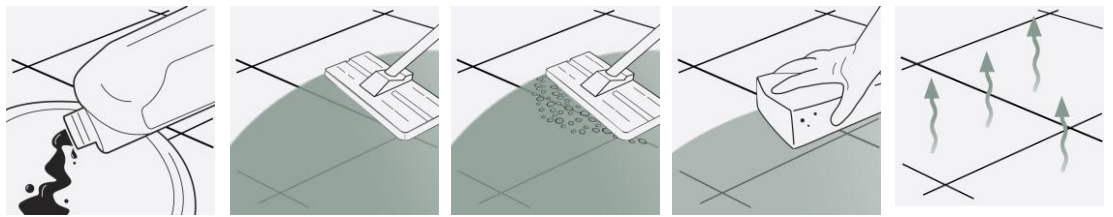

**STEP 1.**  
Dilute solution 1:10 with warm water and apply to the surface.

**STEP 2.**  
Working in manageable areas at a time spread out the solution. Leave for 20 minutes.

**STEP 3.**  
Add a little water and then scrub surfaces and grout joints to release sediment dirt and grime. Use white pad and pad holder.

**STEP 4.**  
Sponge up released residues. Rinse with water a second time and sponge again.

**STEP 5.**  
Allow surfaces to dry before allowing traffic or sealing. (24 hours)

1

### LTP COLOUR INTENSIFIER & STAINBLOCK



### PROTECT AGAINST STAINS - (apply before and after grouting)

**LTP COLOUR INTENSIFIER & STAINBLOCK** – helps protect against water, oil, grease, dirt and grime.  
**TOPPING UP PROTECTION (wet rooms)** – This can be done with LTP Grout & Tile Protector.

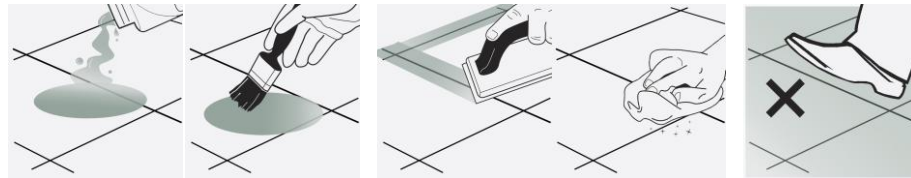

**STEP 1.**  
Surfaces must be clean and dry. Underfloor heating must be off.

**STEP 2.**  
Apply the product to the surface evenly using a brush, soft cloth or sealant applicator pad, allowing 30-60 minutes between coats.

**STEP 3.**  
Once grouted, clean and dry apply final coat of sealer covering grout joints.

**STEP 4.**  
Remove any unabsorbed excess within 15-30 minutes.

**STEP 5.**  
Allow to dry and do not walk on the surface for at least 3 hours.

**STEP 6.**  
Do not make wet or wash treated surfaces for a minimum of 3 days.

2

### LTP GROUT & TILE PROTECTOR

### LTP WAXWASH



### REGULAR AFTERCARE

**LTP WAXWASH** – Maintains sealed natural tile surfaces. Ph Neutral

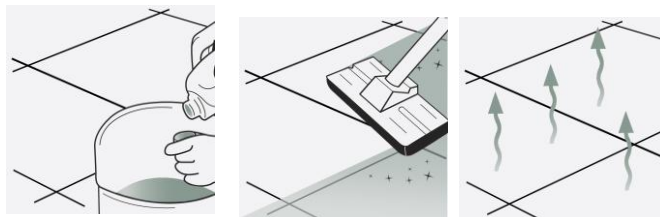

**STEP 1.**  
Dilute 1 capful of cleaner per litre of warm water.

**STEP 2.**  
Mop surfaces with the solution. Do not rinse.

**STEP 3.**  
Allow to dry. Do not walk on surface during drying time. (20 minutes).

A 1ltr LTP Waxwash will wash a 20m<sup>2</sup> floor approx 40 times.



LTP Stonewash

Use LTP Stonewash to clean and maintain stone clad wet rooms and bathrooms.

3



For any LTP product information call our technical helpline  
+ 44 (0) 1823 666213 | [www.ltp-online.co.uk](http://www.ltp-online.co.uk) | [technical@ltp-online.co.uk](mailto:technical@ltp-online.co.uk)  
Tone Est, Milverton Road, Wellington, Somerset, TA21 0AN



# APPLICATION GUIDE 4

## NATURAL STONE - (WET ROOMS AND SWIMMING POOL SURROUNDS)

### APPLICATION BY HAND

Unpolished, Travertine, Limestone, Marble, Sandstone, Slate, Terrazzo and Granite



### EQUIPMENT REQUIRED:

LTP Tools - 4pc pole, pad holder, sealant applicator, white emulsifying pad, deck brush, claw brush, buffing cloths, buckets, sponges, mops. Ensure that any sensitive surfaces not to be cleaned are properly covered and protected before beginning. Ensure that gloves, eye protection and suitable water proof clothing are worn at all times.

## 1 CLEANING AND REFURBISHING – Used and heavily soiled surfaces

- Before sealing the stone should be thoroughly cleaned. Old layers of sealer, residues from aftercare cleaners and deposits must be removed from the surface and the pores of the stone. Film forming layers of sealer can be removed with **LTP Solvex** before washing with **LTP Grimex**.
- Depending upon the levels of dirt, dilute **LTP Grimex** 1:3 with warm water. Apply with a sponge or cloth and leave to sit on the surface for as long as it takes for the dirt to release 5-30 minutes depending upon the level of dirt.
- Agitate the surface using a white emulsifying pad, scrubbing brush or rotary scrubbing machine and leave for a further 5 minutes.
- Continue to scrub while adding clean water. Remove released residues using a sponge and water or extract using a wet vac.
- Rinse thoroughly with clean water to remove any remaining residues.
- For the removal of other types of dirt refer to the table below.
- Do not use acid based cleaners on limestone, marble or any other calciferous stone.

### OTHER TYPES OF DIRT

Care product residues, grease, dirt and light cement films

LTP Grimex or Power Stripper

Tar, wax, paint, bitumen residues old wax layers

LTP Solvex

Deeply engrained oil stains

LTP Spot Stain Remover and LTP Fullers Earth

Cement films on **non calciferous** surfaces

LTP Grout Stain Remover

Rust stains

LTP Rust Stain Remover

## 2 PROTECTIVE SEAL TREATMENTS

- LTP Colour Intensifier & Stainblock** will render the surface water and oil repellent.
- Will help prevent staining, aids cleaning and simplifies the removal of surface stains.
- Provides a barrier of protection that will enhance the appearance of darker coloured stones.
- There are no health concerns once the product has properly cured.
- The seal is micro porous and so can be used on surfaces that have no damp proof course.
- Wet or non-absorbent surfaces cannot be treated as too much moisture will prevent the sealer from properly penetrating the surface.
- LTP Colour Intensifier & Stainblock** is an impregnator which needs to fully absorb.
- Do not allow the product to dry on the surface. Carefully buff with a soft cloth or machine to remove any excess.
- Remove unabsorbed impregnating sealer, if left to dry on the surface, rubbing over with a little more sealer.
- LTP Grout and Tile Protector** can be used to further protect the stone when it is showing signs of water absorption.
- Suitable for internal & external use.

NB. Always test products on an inconspicuous area before general application. Surfaces that are non-absorbent or saturated with moisture cannot be treated. **LTP Colour Intensifier & Stainblock** is an impregnating sealer that needs to fully absorb. Do not allow the product to dry on the surface. Carefully buff with a soft cloth or machine to remove any excess. Remove any unabsorbed impregnating sealer, if left to dry on the surface, by rubbing over with a little more sealer or white spirit.

## 3 AFTERCARE



### LTP Waxwash (for floors)

High quality every day after care cleaner floor wash that is suitable for interior and exterior use.

A gentle cleaner especially formulated to clean natural stone, porcelain and ceramic without damaging the grout, tile or protective treatments, leaving surfaces with a fresh clean fragrance. Suitable for use on both sealed and unsealed, polished and unpolished surfaces. **1ltr of product will wash a 20m<sup>2</sup> floor approx 40 times.**



### LTP Stonewash (for walls)

A gentle surface cleaner, which will clean without breaking down and removing protective sealers.

NB. Always follow detailed instructions on the product labels. Protect acid sensitive stone surfaces from contact with acidic substances. Do not use abrasive materials on honed & polished stones. Avoid using steam cleaners, normal detergents or strong bleach cleaners on sealed surfaces as they will gradually remove the protective seal.

*This information is offered without guarantee. The material should be used so as to take account of the local conditions and the surfaces to be treated. In case of doubt, the product should be tried out in an inconspicuous area*



For any LTP product information call our technical helpline  
 + 44 (0) 1823 666213 | [www.ltp-online.co.uk](http://www.ltp-online.co.uk) | [technical@ltp-online.co.uk](mailto:technical@ltp-online.co.uk)  
 Tone Est, Milverton Road, Wellington, Somerset, TA21 0AN

