

# Application Guide 5

## NATURAL SLATE - INTERNAL APPLICATION

### APPLICATION BY HAND (SURFACE SEAL)

Riven and honed finish



Natural slate has been used on floors and walls for centuries. As with all natural materials, it does require a certain level of care. This is a guide to help ensure that your slate surface remains protected and easy to maintain for many years. High porosity slate may require a pre-seal (impregnating sealer see application guide 5a) prior to the surface seal.

## THREE STEP INSTALLATION INSTRUCTION OVERVIEW (SEE PAGE TWO FOR REFURBISHING EXISTING) MARCH 2022

### LTP GRIMEX

### INITIAL CLEANING OF NEWLY INSTALLED SURFACES

LTP GRIMEX – Cleans and conditions surfaces prior to sealing.

1

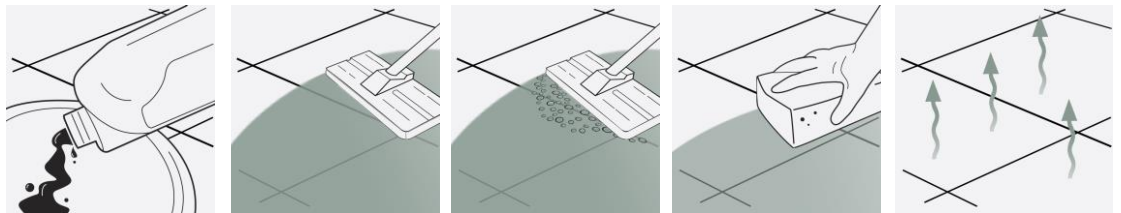

**STEP 1.**  
Dilute solution 1:10 with warm water.

**STEP 2.**  
Working in manageable areas at a time spread out the solution. Leave for 5-10 minutes.

**STEP 3.**  
Add a little water and then scrub surfaces to release sediment dirt and grime. Use emulsifying pad and pad holder.

**STEP 4.**  
Sponge up released residues. Rinse with water a second time and sponge again.

**STEP 5.**  
Allow surfaces to dry before allowing traffic or sealing.

### LTP IRONWAX SATIN OR LTP IRONWAX GLOSS

### PROTECT AGAINST STAINS - (apply before and after grouting)

LTP Ironwax Satin/Gloss – Satin or gloss finish - protects against water, oil, grime and aids maintenance.

Should not be used in wet areas such as shower enclosures or steam rooms.

2

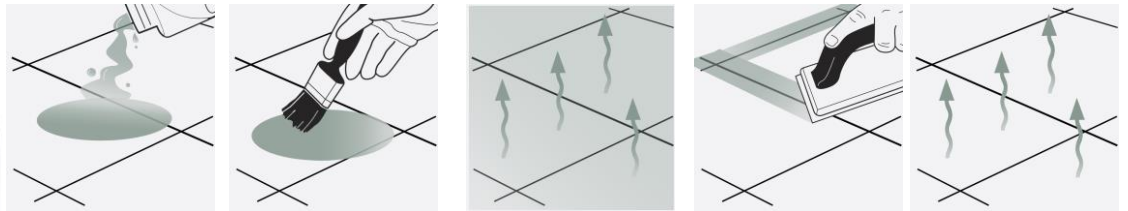

**STEP 1.**  
Before grouting: Apply sealing solution to the surface. Surfaces must be clean and dry.

**STEP 2.**  
Spread out evenly using a sponge or brush (for riven) J cloth or sealant applicator pad (smooth/honed). Do not buff.

**STEP 3.**  
Allow to dry. Apply more coats (avg 3)

**STEP 4.**  
Once grouted, for a higher sheen further coats can be applied at right angles to the previous (max 6)

**STEP 5.**  
Protect from water for 24 hours and do not wash surfaces for at least 3 days.

### LTP FLOORSHINE

### REGULAR AFTERCARE

LTP FLOORSHINE – Ph Neutral

3

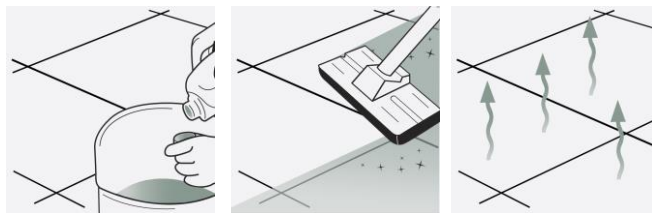

**STEP 1.**  
Dilute 1 capful of cleaner per litre of warm water.

**STEP 2.**  
Mop surfaces with the solution. Do not rinse.

**STEP 3.**  
Allow to dry. Do not walk on surface during drying time. (20 minutes).

A 1ltr LTP Floorshine will wash a 20m<sup>2</sup> floor approx 40 times.



For any LTP product information call our technical helpline  
 + 44 (0) 1823 666213 | [www.ltp-online.co.uk](http://www.ltp-online.co.uk) | [technical@ltp-online.co.uk](mailto:technical@ltp-online.co.uk)  
 Tone Est, Milverton Road, Wellington, Somerset, TA21 0AN



# Application Guide 5

## NATURAL SLATE - INTERNAL APPLICATION

### APPLICATION BY HAND (SURFACE SEAL)

Riven and honed finish



#### EQUIPMENT REQUIRED:

LTP Tools - 4pc pole, pad holder, sealant applicator, white or black emulsifying pad, deck brush, claw brush, buffing cloths, buckets, sponges, mops. Ensure that any sensitive surfaces not to be cleaned are properly covered and protected before beginning. Ensure that gloves, eye protection and suitable water proof clothing are worn at all times.

## 1 CLEANING AND REFURBISHING – used and heavily soiled surfaces

- Before sealing, the slate should be thoroughly cleaned. Old layers of sealer, residues from aftercare cleaners and deposits must be removed from the surface and the pores of the stone. Stubborn film forming layers of sealer can be removed with **LTP Solvex** before washing with **LTP Grimex**.
- Dilute **LTP Grimex** 1:3 with water and apply to the surface. This should be left for 5-30 minutes depending on the level of dirt.
- Agitate the surface using an emulsifying pad, scrubbing brush or rotary scrubbing machine.
- Continue to scrub while adding clean water. Remove released residues using a sponge and water or extract using a wet vac.
- Rinse thoroughly with clean water to remove any remaining residues.
- Surfaces should be thoroughly dry before sealing.
- For the removal of other types of dirt see the table below.

#### OTHER TYPES OF DIRT

|   |                         |
|---|-------------------------|
| Cement and grout residue                          | LTP Grout Stain Remover |
| Tar, wax, paint, bitumen and epoxy grout residues | LTP Solvex              |
| Deeply engrained oil stains                       | LTP Grimex              |
| Rust stains                                       | LTP Rust Stain Remover  |

## 2 PROTECTIVE SEAL TREATMENTS

- LTP Mattstone, LTP Mattstone H20 (see guide 5a) and LTP Ironwax Satin or Gloss** will render the surface water and oil repellent.
- These products will help prevent staining, aid cleaning and simplify the removal of stains.
- LTP Ironwax Satin and Gloss** provide a hard wearing sheen.
- There are no health concerns once the product has properly cured.
- LTP Mattstone H20 and LTP Mattstone** are micro porous and so can be used on surfaces that have no damp proof course.
- LTP Mattstone H20 and LTP Mattstone** are suitable for internal and external use. **LTP Ironwax Satin or Gloss** are for internal use only.
- If surfaces are properly maintained we recommend topping up the protective treatment every 3 – 4 years.

NB. Always test products on an inconspicuous area before general application. Surfaces that are non absorbent or saturated with moisture cannot be treated. **LTP Mattstone and LTP Mattstone H20** are impregnating sealers that need to be fully absorbed. Any un-absorbed sealer should be buffed off with a micro-fibre cloth or machine with white pad to remove the excess. Some slates may be darker after application. **LTP Ironwax Satin or Gloss** should not be used in wet areas such as shower enclosures or steam rooms.

## 3 AFTERCARE



#### LTP Floorshine

Cleans and protects in one application. Used routinely it will reinforce protection offered by **LTP Ironwax Satin and LTP Ironwax Gloss**.



#### LTP Waxwash

**High quality, every day after care cleaner floor wash that is suitable for interior and exterior use.**

A gentle cleaner especially formulated to clean natural stone, slate, terracotta and quarry without damaging the grout, tile or protective treatments, leaving surfaces with a fresh clean fragrance. **1ltr of product will wash a 20m<sup>2</sup> surface approx 40 times.**

NB. Always follow detailed instructions on the product labels. Do not use abrasive materials to clean. Avoid using steam cleaners, normal detergents or strong bleach cleaners on sealed surfaces as they will gradually remove the protective seal.

*This information is offered without guarantee. The material should be used so as to take account of the local conditions and the surfaces to be treated. In case of doubt, the product should be tried out in an inconspicuous area*



For any LTP product information call our technical helpline  
 + 44 (0) 1823 666213 | [www.ltp-online.co.uk](http://www.ltp-online.co.uk) | [technical@ltp-online.co.uk](mailto:technical@ltp-online.co.uk)  
 Tone Est, Milverton Road, Wellington, Somerset, TA21 0AN

