

# APPLICATION GUIDE 6

## POLISHED PORCELAIN (Including Nano treated)

### APPLICATION BY HAND

Highly fired, machine polished, full bodied clay tiles.  
Including Super Black & Super White



Mechanically polished porcelain will normally require a certain level of care. The following is a guide to help ensure that treated surfaces remain protected and easy to maintain for many years.

## THREE STEP INSTALLATION INSTRUCTION OVERVIEW (SEE PAGE TWO FOR REFURBISHING EXISTING) March 2022

### LTP GRIMEX

### INITIAL CLEANING OF NEWLY INSTALLED SURFACES

LTP GRIMEX INTENSIVE CLEANER – Cleans and conditions surfaces before sealing

1

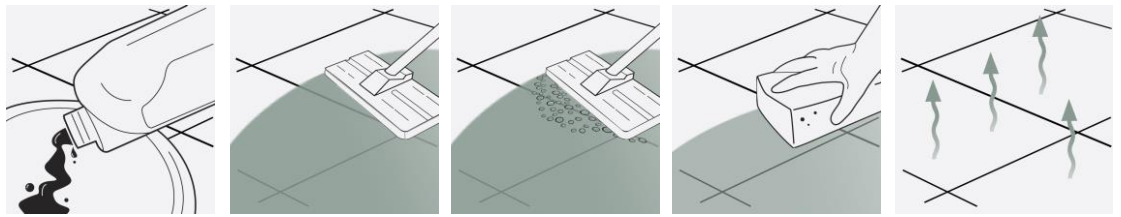

**STEP 1.**  
Dilute solution 1:10 with warm water and apply to the surface.

**STEP 2.**  
Working in manageable areas at a time spread out the solution. Leave for 20 minutes.

**STEP 3.**  
Add a little water and then scrub surfaces to release excess nano wax. Use white pad and pad holder.

**STEP 4.**  
Sponge up released residues. Rinse with water and sponge again.

**STEP 5.**  
Allow surfaces to dry before allowing traffic or sealing.

### LTP MPG SEALER (POLISHED PORCELAIN SEALER)

### PROTECT AGAINST STAINS - (apply before and after grouting)

LTP MPG SEALER - protects against water, grout ingress and daily dirt and grime

2

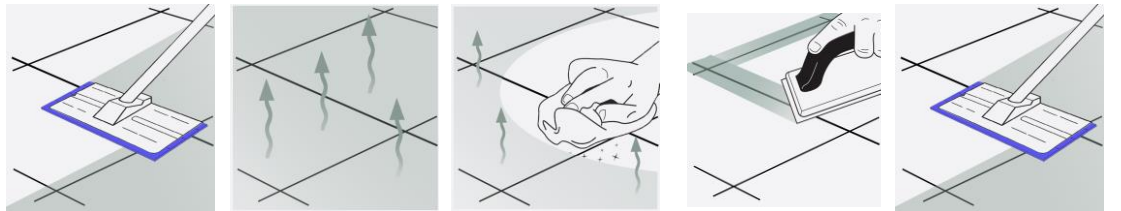

**STEP 1.**  
Before grouting: Apply sealing solution to the surface. Spread out evenly using a sealant applicator pad and pad holder.

**STEP 2.**  
Allow sealer to absorb for up to 20 minutes. Do not allow the sealer to dry on the surface.

**STEP 3.**  
Remove any residual sealer within 20 minutes. This should be done while it is still wet. Buff to finish using a micro-fibre cloth or buffing machine.

**STEP 4.**  
After removing all excess leave sealer to cure overnight before grouting the joints. Clean off grout residues and leave to dry.

**STEP 5.**  
Once fully dry apply a final coat of sealer covering the joints as well. This should be applied using the same method.

### LTP PORCELAIN FLOOR TILE CLEANER

### REGULAR AFTERCARE

LTP PORCELAIN FLOOR TILE CLEANER – Ph Neutral

3

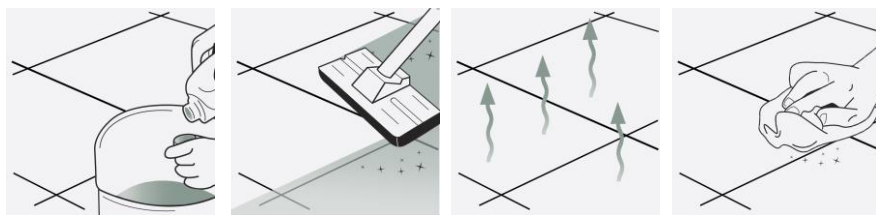

**STEP 1.**  
Dilute 1 capful of cleaner per litre of warm water.

**STEP 2.**  
Mop surfaces with the solution. Do not rinse.

**STEP 3.**  
Allow to dry. Do not walk on surface during drying time. (20 minutes).

**STEP 4.**  
For best results buff polished surfaces with a microfibre cloth or machine to finish

A 1ltr of cleaner will wash a 20m<sup>2</sup> floor approx 40 times.



For any LTP product information call our technical helpline  
+ 44 (0) 1823 666213 | [www.ltp-online.co.uk](http://www.ltp-online.co.uk) | [technical@ltp-online.co.uk](mailto:technical@ltp-online.co.uk)  
Tone Est, Milverton Road, Wellington, Somerset, TA21 0AN



## APPLICATION GUIDE 6

# POLISHED PORCELAIN (Including Nano treated)

### APPLICATION BY HAND

Highly fired, machine polished, full bodied clay tiles.  
Including Super Black & Super White



## EQUIPMENT REQUIRED:

LTP Tools - 4pc pole, pad holder, sealant applicator, white or black emulsifying pad, deck brush, claw brush, buffing cloths, buckets, sponges, mops.

Ensure that any sensitive surfaces not to be intensively cleaned are properly covered and protected before beginning. Ensure that gloves, eye protection and suitable protective clothing are worn at all times.

## 1 CLEANING AND REFURBISHING – used and heavily soiled surfaces

- Before sealing the porcelain should be thoroughly cleaned. Old layers of sealer, residues from aftercare cleaners and deposits must be removed from the surface and the pores of the porcelain.
- Dilute LTP Grimex 1:3 in warm water, apply to the surface liberally spreading over surface of the tiles for as long as it takes for the dirt to release. 5-30 minutes depending on the level of dirt. NB. For stubborn stains such as pencil marks, and residual mortar use LTP Grout Stain Remover instead.
- Agitate the surface using a white emulsifying pad, scrubbing brush or rotary scrubbing machine and leave for a further 5 minutes.
- Continue to scrub while adding clean water. Remove released residues using a sponge and water or extract using a wet vac.
- Rinse thoroughly with clean water to remove any remaining residues.
- Surfaces should be thoroughly dry before applying the protective seal.
- For the removal of other types of dirt see the table below.
- Do not use acid based cleaners on **super black polished porcelain**. If you are unsure please call our helpline for advise.

### OTHER TYPES OF DIRT

Care product residues, oil, grease and dirt

LTP Grimex or LTP Powerstripper

Wax and acrylic layers, paint and epoxy grout residues

LTP Solvex

Light cement films and lime residues

LTP Grout Stain Remover

Rust stains

LTP Rust Stain Remover

## 2 PROTECTIVE SEAL TREATMENTS

- LTP MPG Sealer** will render the surface water and oil repellent.
- This will help prevent staining, aid cleaning and simplify the removal of stains.
- LTP MPG Sealer** will not greatly alter the character of treated surfaces.
- There are no health concerns once the product has properly cured.
- The seal is micro porous and so can be used on surfaces that have no damp proof course.
- Cleaned appropriately using **LTP Porcelain Floor Tile Cleaner** we would suggest topping up the protective treatment every 3 – 4 years.
- Suitable for internal use.

NB. Always test products on an inconspicuous area before general application. Surfaces that are non absorbent or saturated with moisture cannot be treated. **LTP MPG Sealer** is an impregnating sealer that needs to fully absorb. Any un-absorbed sealer should be buffed off with a micro-fibre cloth or machine with white pad to remove the excess. Some stones may be darker after application. Acidic substances, if left on the surface of Super Black or Super White porcelain, may cause damage, even after treatment.

## 3 AFTERCARE



### LTP Porcelain Floor Tile Cleaner

**High quality every day after care floor cleaner that is suitable for interior and exterior use.**

A gentle cleaner especially formulated for all types of porcelain and glazed ceramic. Cleans without damaging the grout, tiles or protective treatment, leaving surfaces with a fresh clean fragrance. Suitable for use on both sealed and unsealed, polished and unpolished surfaces. **1ltr of product will wash a 20m<sup>2</sup> surface approx 40 times.**

NB. Always follow detailed instructions on the product labels. Do not use overly abrasive materials on honed and polished porcelains. Avoid using steam cleaners, normal detergents or strong bleach cleaners on sealed surfaces as they will gradually remove the protective seal.

*This information is offered without guarantee. The material should be used so as to take account of the local conditions and the surfaces to be treated. In case of doubt, the product should be tried out in an inconspicuous area*



For any LTP product information call our technical helpline  
+ 44 (0) 1823 666213 | [www.ltp-online.co.uk](http://www.ltp-online.co.uk) | [technical@ltp-online.co.uk](mailto:technical@ltp-online.co.uk)  
Tone Est, Milverton Road, Wellington, Somerset, TA21 0AN

