

APPLICATION GUIDE 9

TERRACOTTA – TRADITIONAL METHOD

APPLICATION BY HAND

Hand or machine made low fired clay tiles.



The following is a traditional cleaning and sealing guide for terracotta floor tiles. The products and methods specified should ensure that surfaces are suitably conditioned before sealing. Future cleaning and aftercare then made easier following the application of a natural oil based sealer and finishing with a natural wax to protect the surface.

FOUR STEP INSTALLATION INSTRUCTION OVERVIEW (SEE PAGE TWO FOR REFURBISHING EXISTING)

2025

LTP GRIMEX

CONDITIONING & CLEANING THE SURFACE (before sealing & grouting)

LTP GRIMEX: Cleans and removes grease, dirt & grime.

1

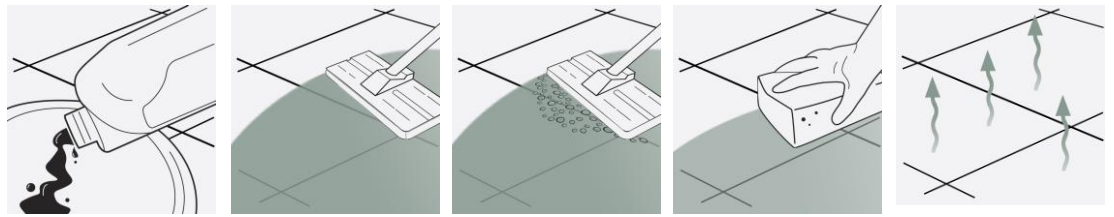

STEP 1.

Dilute solution 1:10 with warm water and apply to the surface.

STEP 2.

Working in manageable areas at a time, spread out the solution. Leave for 15 minutes.

STEP 3.

Agitate the surface to remove any dust and grime.

STEP 4.

Sponge up released residues. Rinse with water a second time and sponge again.

STEP 5.

Allow surfaces to dry before allowing traffic or sealing.

LTP BOILED LINSEED OIL

PROTECT AGAINST STAINS - (apply before grouting)

LTP BOILED LINSEED OIL – Traditional oil based impregnating sealer.

2



STEP 1.

Apply sealer to the surface of the terracotta & spread out evenly using a brush

STEP 2.

Allow sealer to absorb naturally. Underfloor heating must be off.

STEP 3.

Apply further coats at 4 hour intervals until the terracotta is fully saturated.

STEP 4.

1 hour after applying the final coat of oil, dry buff the surface using an absorbent towel to remove any excess.

STEP 5.

Newly sealed surfaces should be left to dry for a minimum of 12 hours before allowing heavy traffic or waxing.

LTP CLEAR OR LTP ANTIQUE WAX

PROTECT THE SURFACE AFTER SEALING - (apply before and after grouting)

LTP CLEAR WAX or LTP ANTIQUE WAX – Will help protect against water, oil, grease, dirt, grime and aid maintenance.

3

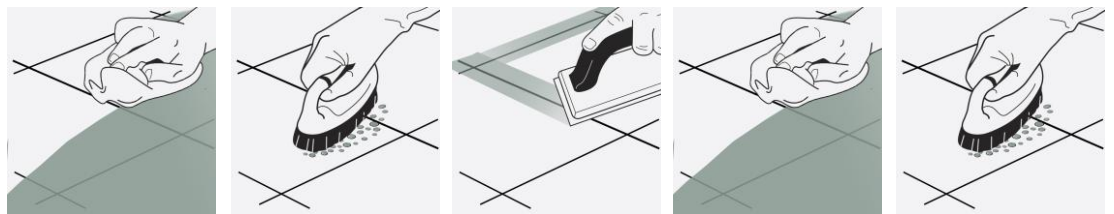

STEP 1.

Apply generously and work into the surface with a cloth.

STEP 2.

Leave the wax for 20 minutes and then buff to a shine using a stiff scrubbing brush.

STEP 3.

Leave wax to cure for 1 hour and then grout the joints.

STEP 4.

Once residual grout has been removed with LTP Grout Stain Remover, after 12 hours apply a further coat of wax covering the joints as well.

STEP 5.

Leave the wax for 20 minutes and then buff to a shine with a stiff brush. Allow light traffic for the first 12 hours and do not wash surfaces for 3 days.



For any LTP product information call our technical helpline
 + 44 (0) 1823 666213 | www.ltp-online.co.uk | technical@ltp-online.co.uk
 Tone Est, Milverton Road, Wellington, Somerset, TA21 0AN



APPLICATION GUIDE 9

TERRACOTTA – TRADITIONAL METHOD

APPLICATION BY HAND

Hand or machine made low fired clay tiles.



LTP WAXWASH



REGULAR AFTERCARE

LTP WAXWASH – Maintains sealed natural tile surfaces. Ph Neutral

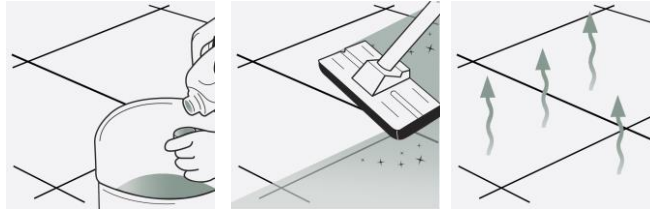

STEP 1.

Dilute 1 capful of cleaner per litre of warm water.

STEP 2.

Mop surfaces with the solution. Do not rinse.

STEP 3.

Allow to dry. Do not walk on surface during drying time. (20 minutes).

A one litre of LTP Waxwash will wash a 20m² floor approx 40 washes.

4

EQUIPMENT REQUIRED:

LTP Tools - 4pc pole, pad holder, sealant applicator, white emulsifying pad, deck brush, claw brush, buffing cloths, buckets, sponges, mops.

Ensure that any sensitive surfaces not to be cleaned are properly covered and protected before beginning. Ensure that gloves, eye protection and suitable water proof clothing are worn at all times.

1 CLEANING AND REFURBISHING – Used and heavily soiled surfaces

- Before sealing, the terracotta should be thoroughly cleaned. Old layers of sealer, residues from aftercare cleaners and deposits must be removed from the surface and the pores of the terracotta.
- Firstly, remove any old layers of wax with **LTP Solvex**. Apply the solution undiluted to the face of the tile and spread around evenly with a paint brush or soft cloth. Leave for 5-10 minutes and then rub with a cloth to remove the old layers of wax. Do not allow the solution to dry on the surface. Remove any residues with **LTP Grimex**.
- Agitate the surface using a white emulsifying pad, scrubbing brush or rotary scrubbing machine and leave for a further 5 minutes.
- Continue to scrub while adding clean water. Remove released residues using a sponge and water or extract using a wet vac.
- Rinse thoroughly with clean water to remove any remaining residues.
- Allow the surfaces to dry for a minimum of 24 hours before applying the protective sealer.
- For the removal of other types of dirt refer to the table below.

OTHER TYPES OF DIRT

Care product residues, oil, grease and dirt	LTP Grimex or Power Stripper
Wax and acrylic layers, tar,paint,bitumen residues	LTP Solvex and then LTP Grimex
Deeply engrained oil stains	LTP Grimex
Rust Stains	LTP Rust Stain Remover



For any LTP product information call our technical helpline
 + 44 (0) 1823 666213 | www.ltp-online.co.uk | technical@ltp-online.co.uk
 Tone Est, Milverton Road, Wellington, Somerset, TA21 0AN



TERRACOTTA – TRADITIONAL METHOD

APPLICATION BY HAND

Hand or machine made low fired clay tiles.



2 PROTECTIVE SEAL TREATMENTS

- **LTP BOILED LINSEED OIL and then LTP CLEAR or LTP ANTIQUE WAX** will render the surface water and oil repellent.
- Will help prevent staining, aids cleaning and simplifies the removal of surface stains.
- LTP Boiled Linseed Oil & Clear wax will deepen the colour and alter the surface character.
- There are no health concerns once the product has properly cured.
- For older surfaces that have no damp proof course use either LTP Mattstone Or LTP Colour Intensifier & Stainblock. They are micro porous and will allow the tiles to breathe.
- LTP Mattstone or LTP Colour Intensifier & Stainblock are suitable for internal and external use.
- LTP Clear or Antique Wax are for internal use only.
- If surfaces are properly maintained we recommend touching up the protective treatment every 3-4 years

NB. Always test the product on an inconspicuous area. Wet or non absorbant surfaces cannot be treated. LTP Boiled Linseed Oil, LTP Mattstone and LTP Colour Intensifier & Stainblock are impregnators which need to fully absorb. Do not allow them to dry on to the surface. Carefully buff with a soft cloth or machine to remove any excess. Remove unabsorbed impregnating sealer, if left to dry on the surface, by rubbing over with a little more sealer. Some tiles may be darker after application. Over applied boiled linseed oil that is difficult to remove should be rubbed over with a little white spirit. This should be done while it is still soft on the surface. If LTP Boiled Linseed has dried to form a patchy lacquer remove with LTP Solvex.

3 AFTERCARE



LTP WAXWASH (for floors)

High quality every day after care cleaner floor wash that is suitable for interior and exterior use.

A gentle cleaner especially formulated to clean natural stone, porcelain and ceramic without damaging the grout, tile or protective treatments, leaving surfaces with a fresh clean fragrance. Suitable for use on both sealed and unsealed, polished and unpolished surfaces.

1 ltr of product will wash a 20 m² surface approx 40 times.

NB. Always follow the detailed instructions on the product labels. Avoid using steam cleaners, normal detergents or strong bleach cleaners on sealed surfaces as they will gradually remove the protective seal.

This information is offered without guarantee. The material should be used so as to take account of the local conditions and the surfaces to be treated. In case of doubt, the product should be tried out in an inconspicuous area



For any LTP product information call our technical helpline
 + 44 (0) 1823 666213 | www.ltp-online.co.uk | technical@ltp-online.co.uk
 Tone Est, Milverton Road, Wellington, Somerset, TA21 0AN

